



Friday 19th to Monday 22nd July 2024

Freemen's Common Campus, University of Leicester, LE2 6BF

Programme Booklet 2024

WHEN YOU ARRIVE....

The ManorCon Registration Desk is in the Freeman's Common City Reception area, which is a short walk from the car park. This is where you collect your badge if you have pre-booked and where you pay any monies owing.

On the door Registration is £8 for one day, £12 for the weekend.

Collecting Room Key

If you have pre-booked a room, then you should have received a Room Chit by email (check your spam if you have not received it). Present your Room Chit, either electronically or a print-out, at Freeman's Common Reception. If you didn't receive your Room Chit then don't panic; you can collect a copy from the Registration Desk when you arrive.

Contact Details

Committee – for Convention Help

The committee members are, Steve Jones (Chair), Mark Stretch (Treasurer), David Norman (Webmaster), Gary Duke (Bookings & Registration Desk), Rachel Coe (Publicity), Nick Harrison and Dave Simpson.

For problems relating to the convention, please seek out the Committee Member on Duty so that they can be dealt with promptly.

To find the Committee Member on Duty

1. Look for the helium balloon.
2. Ask at the ManorCon Registration Desk as often a committee member will be there.
3. Ring the ManorCon mobile on 07391 046 410.

University for Housekeeping Issues

For university related issues, such as an issue with the accommodation, please contact Freeman's main reception in person or by phone at 0116 252 3109.

This covers problems with your room (e.g. your key doesn't work, the light bulb's blown, etc), or general "housekeeping" problems such as blocked or flooded toilets, or if your room hasn't been cleaned and serviced.

If you accidentally break anything, please report it to a committee member or to the Reception. It is very embarrassing if damage goes unreported and is discovered by the site staff.

Accommodation

All rooms are situated in the Mary Attenborough building, entrances 1 & 4 will be used for the convention rooms.

All accommodation is in single, ensuite rooms located within the campus. Each room is within a flat of typically 6 rooms with shared kitchen facilities are available. The beds are small doubles (4' wide). Full English breakfast is included.

In individual room items:

- Full bed linen - white
- Standard toiletries
- Hand and bath towel
- Bath mat

In Flat items:

- Fridge/freezer, microwave, kettle, cooker/hob
- Dining tables
- Tea and Coffee making facilities refreshed daily in flat kitchens
- Kitchen packs also include cleaning products for the kitchens (washing up liquid, anti-bac, all COSHH compliant products)

Bedrooms and bathrooms serviced daily, this starts at 9.30am, this includes making beds.

PLEASE NOTE: you **must** vacate your room and return your key by 9:30am on the day of your departure. All room keys should be returned to the ManorCon Registration Desk or directly to the university.

EXPECTATIONS

ManorCon is a welcoming, inclusive convention and we ask attendees to follow the five expectations below:

1. Be Welcoming – Some attendees may be new to gaming or have different interests. Don't be dismissive, harass, or put off others.
2. Be Respectful – Respect others equally, everyone is welcome at ManorCon.
3. Be Fair – Don't leave a game part way through unless agreed by others, don't place games on a table and not use it.
4. Have Good Hygiene – There are over 200 people at ManorCon, we all should be clean and fragrant for the benefit of everyone.
5. Drink Responsibly – Real Ales and other alcohol are available, please be responsible and don't push others to drink if they don't wish to.

Harassment, discrimination, and prejudice will not be tolerated. This includes, but is not limited to:

- Verbal comments that reinforce social structures of domination, whether related to gender, gender identity and expression, sexual orientation, disability, physical appearance, body size, race, age, or religion.
- Sexual images in public spaces.
- Deliberate intimidation, stalking, or following.
- Harassing photography or recording.
- Sustained disruption of talks or other events.
- Inappropriate physical contact.
- Unwelcome sexual attention.
- Advocating for, or encouraging, any of the above behaviour.

Please speak to a committee member if required.

SITE MAPS

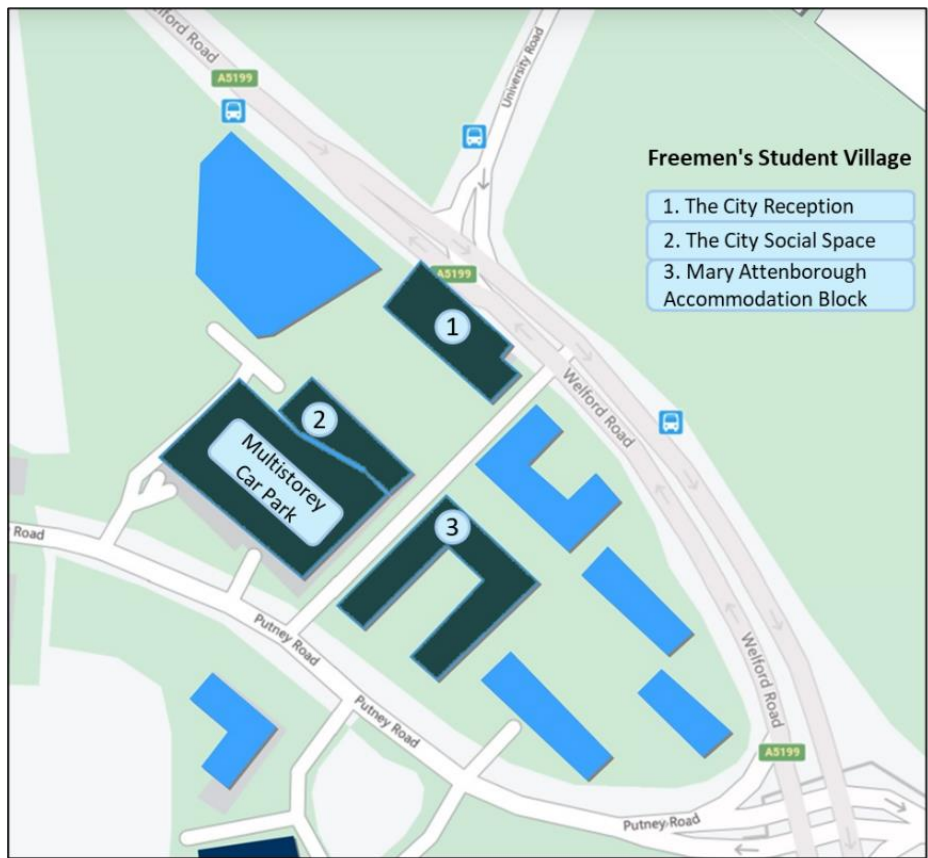

The City Reception - Ground Floor

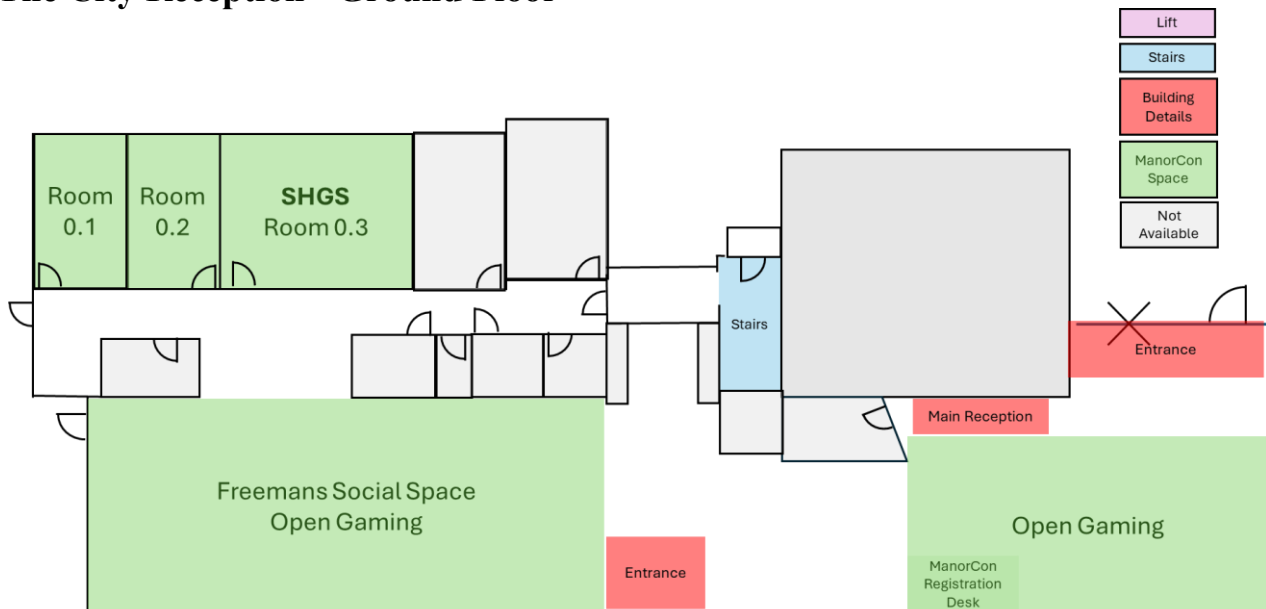

The City Reception - First Floor Quiet Gaming

The first floor is the quiet gaming area. Please be respectful when using this area.

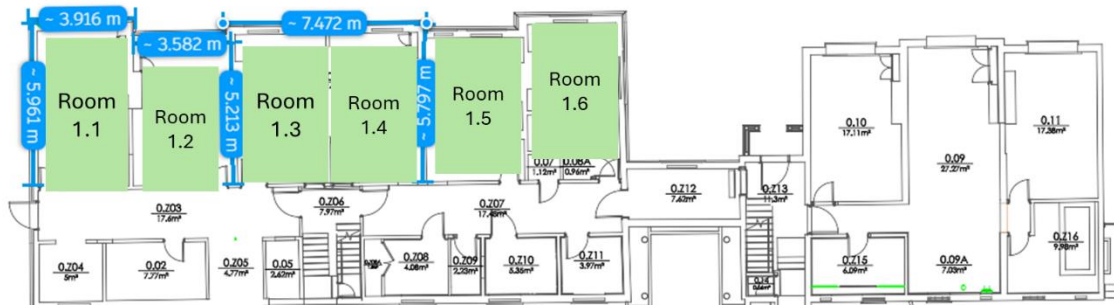

The City Social Space – Ground Floor

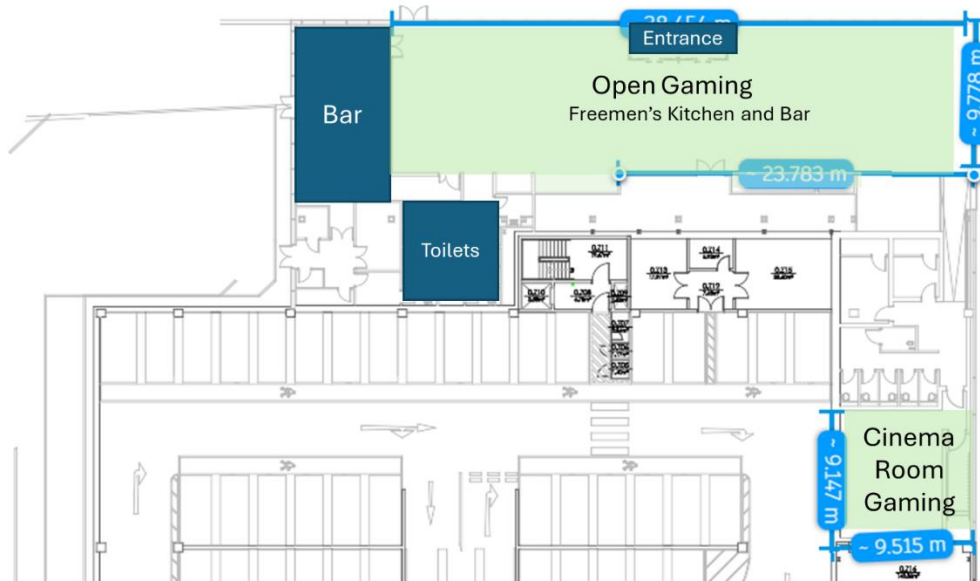

Mary Attenborough Common Room

The Common Room (approx. 5m x 11.4m) can be accessed through Entrance 1 and will be accessible with bedroom fobs.



KEY TIMES

Meal and Bar Times

Meal Times

Breakfast: 08:00 to 09:30
Lunch: 12:30 to 14:00
Dinner: 17:30 to 20:00

Bar Times

Friday: 14:00 to 01:00
Saturday: 12:00 to 01:00
Sunday: 12:00 to 01:00
Monday: 12:00 to 14:00

Treasure Hunt

The treasure hunt will be at 2pm Sunday in the bar.

Midnight Party

The midnight party will be run at midnight each night in the bar, hosted by Steve Guest.

Room Check Out Time

You **must** vacate your room and return your key by 9:30am on the day of your departure.

Convention Close

The convention will close at 2pm on Monday with games having to finish before this time.

FOOD AND DRINK

Breakfast, lunch and dinner will be served in the Freeman's Kitchen and Bar. There will be other snacks available to purchase and the menu provided is specific to the convention. Only alcohol purchased in the bar can be consumed in the public gaming areas due to the licensing rules.

The bar should be open 2pm on Friday until 1am, noon on Saturday and Sunday until 1am, and noon to 2pm on Monday. The bar may close early if not doing much business.

The University operates a cashless bar and restaurant.

Tea and coffee is provided in flat kitchens and will be refreshed daily, beverages are also available to purchase at Freeman's Kitchen and Bar.

Water will be available through water holders to be placed in the Kitchen and Bar, additionally water is sold at the bar or available from the flat kitchens.

Dietary requirements

The university provides vegetarian, gluten free and dairy free options. If you are concerned, please speak to a member of staff before ordering. If you wish to provide your own meals, everyone has access to kitchens with cookers, microwaves, freezers, etc, so you can cook your own meals.

Convention Specific Menu

	Friday	Saturday	Sunday	Monday
Breakfast: 08:00 to 09:30 (Served in chaffing units)		Sausage / Vegetarian Sausage, Back bacon, Eggs, Hash browns, Tomatoes, Baked Beans. (Served in chaffing units) Toast (brown and white bread), Cereals, Fruit Yoghurts, Jam / Honey/ Butter / Flora, Milk / Soya Milk, Tea and Coffee		
Lunch: 12:30 to 14:00 (Cooked to order)		Saturday and Sunday Selection of Sandwiches and Filled Baguettes (Tiffin) Selection of toasted Paninis and Ciabattas (Tiffin) Burgers £10.95 <ul style="list-style-type: none"> • Buttermilk Chicken fillet burger: Buttermilk Chicken fillet burger Topped with Crispy Onions, Cheddar Cheese Slice & garlic mayo. • Cheese and Bacon Burger: 6oz Beef burger, with salad, tomatoes, gherkins, Cheddar Cheese Slice, Crispy Onions. • Vegan Burger (Ve): Vegan burger patty, with salad, tomatoes, gherkins, Vegan Cheese Slice, Crispy Onions. All served in a Brioche Bun with crinkle wedges & coleslaw. McCain Loaded “Crisper” V crinkle cut wedges £7.95 Topped with either <ul style="list-style-type: none"> • In house Chilli con carne, Nacho’s cheese sauce, Guacamole & sour cream £7.95 • In house Three bean chilli, Nacho’s cheese sauce, Guacamole & sour cream £7.95 The BIG Wedge Tasty large pizza slice with potato wedges & slaw £9.95		A range of hot and cold items available to purchased.
Dinner: 17:30 to 20:00 (Served in chaffing units)	Beer Battered Fish £10.95 Served with chunky chips, minted mushy peas and lemon wedge. Glazed Caribbean Chicken £10.95 Served with Rice & Peas, sourdough flatbread & Caribbean style salad. Mediterranean Vegetable Ragu £9.95 Served with penne pasta and garlic bread. Selection of Desserts £3.95	Butter Chicken Curry £10.95 Served with braised Pilaf rice, Garlic and herb naan bread and mango chutney Beef Lasagne £10.95 Served with garlic bread, fresh crisp salad & in house coleslaw Veggie Samosa Chaat £9.95 Handmade Samosa topped with Chickpea curry, minted yogurt and Bombay mix. Selection of Desserts £3.95	Slow Roasted shoulder of pork £10.95 Served giant Yorkshire pudding filled with hand caved tender roast pork with roasted root vegetables, Cauliflower cheese & roast potatoes and gravy. Sweet potato, spinach and goats cheese pie (V) £10.95 Served with roasted root vegetables, Cauliflower cheese & roast potatoes and gravy. Selection of Desserts £3.95	

Drinks including Real Ale

We have requested the following real ales with 4 real ales being available to drink at one time.

Westway Pale ale	Stiff lip IPA	Star Bitter
Quaffer Pale ale	Silver Heart IPA	Bantam Best Bitter
Ainsty Angel Pale ale	Off the Hook	JRT Golden best bitter
Flummoxed Farmer session Blonde		Hooky
		OLD Hooky

In addition, it is a stocked bar there is the following on tap for sale

- Lager: Heineken and Moretti
- Cider: Inch's and Strongbow dark fruits
- Guinness
- Beavertown Neck Oil IPA/Bitter

OPEN GAMING

Some people like to arrange games in advance while others prefer to arrange games on the day. The convention provides options to accommodate all.

Gaming rooms

Gaming will take place in The City Social Space, The City Reception Building and Mary Attenborough Accommodation including common room. Specific rooms are allocated for quiet gaming. All gaming rooms may be locked up for some period overnight; the exact details are not yet known.

Online Organiser

An online Games Organiser is available via googlesheets. Each day has a tab, along with a wish list for games you'd like to play to try and match people, along with the option for you to include a link to your bgg collection.

[ManorCon XL Games organiser - Google Sheets, or use https://tinyurl.com/nhzdkd8t](https://tinyurl.com/nhzdkd8t)

Players Wanted Signs

Players wanted signs will be provided, they will be available at the reception desk.

GAMES FOR SALE

Games Stall

Meeple World have the sole right to sell first-hand games at ManorCon, and anybody else wanting to do so must speak to the committee first. A discount of at least 10% will be available on all purchases at the convention.

Second Hand Games Sale (SHGS)

Manorcon provides an opportunity for buyers and sellers of second-hand games to meet and complete transactions. The second-hand games sale will be open from 4pm on Friday 19 July 2024 until 10am on Monday 22 July 2024. Sellers will be able to place their games in Room 3 in Freeman's City Reception from 3pm and potential buyers will be able to peruse the games at their leisure throughout the convention. The room will be locked each night from 9pm to 9:30am.

Buyers will contact the sellers and pay them directly, with ManorCon providing suitable space for the games. Games are sold as seen and the transaction is between the buyer and the seller. ManorCon accepts no responsibility for any damage or missing components in items sold.

Please do not bring games as new/in shrink which will be available for sale by the onsite Retailer to sell at the SHGS. We do understand that some games you have may be as new / in shrink that not available in retail and these are allowed.

Please see the following the <http://manorcon.org.uk/shgs/> for full details on how to use the SHGS, either as a buyer or seller. Philip Honeybone is organising the SHGS. The games for sale list is [here](https://tinyurl.com/muuneaa) <https://tinyurl.com/muuneaa>.

TOURNAMENTS & QUIZZES

Treasure Hunt

Phil Hanney will be running the Treasure Hunt in the bar on Sunday.



"THE SUN IS MISSING! THE SUN IS MISSING!" CRIED THE FOOL.

FOLLOW THE FOOL'S JOURNEY, SOLVING PUZZLES ALONG THE WAY TO FIND THE MISSING SUN. THIS YEAR'S MANORCON TREASURE HUNT WILL TAKE PLACE ON SUNDAY AFTERNOON AT 2PM FOR UP TO 8 TEAMS OF 5. TO SECURE A PLACE PLEASE USE THE SIGN-UP SHEET. OR FEEL FREE TO JUST COME ALONG AND WE'LL FIT YOU IN IF WE CAN AND FORM TEAMS AS APPROPRIATE.

18XX

There will be an ad-hoc tournament for 18XX, organised by Steve Jones; just play, record the results on the forms provided, and put them in the envelope(s) provided.

Midnight Party

The Midnight party is a three-round tournament played late on the Friday, Saturday and Sunday nights in the bar during the convention, and is run by Steve Guest. Each round starts at Midnight, with the idea of the game being to avoid being caught by Hugo the Ghost in a kind of musical chairs in which a limited number of rooms (to hide in) take the place of the chairs. It started many years ago as an unofficial event but has become more and more popular (and cultish) each year. Each round takes about 45 minutes, and it is very easy to learn how to play.

LOCAL INFORMATION

Restaurants

While tripadvisor and google provide the latest information on bars and restaurants in Leicester, below are a couple recommended. We have no link to these places apart from enjoying their offerings.

[Kayal](#) 153, Granby Street, Leicester, LE1 6FE South Indian, Kerala Cuisine.

[Udupi Shivalli](#), 21 Welford Road, Leicester LE2 7AD, Vegetarian, Brahmin Cuisine.

Supermarkets

The nearest supermarket to The City is a Morrison's superstore located on Aylestone Road, LE2 7LT. It's approximately 10 minutes' walk away. There's also plenty of shops around in the Clarendon Park area, a short walk away.

ATM

The closest ATM is situated at Morrisons Supermarket.

Taxi's

There are three firms that have been used for travel from the previous Oadby location to Leicester City Centre.

- Victoria Cabs (0116 270 6655)
- Gold Line (0116 273 1110)
- Direct Taxis (0116 272 1000)

Note it was difficult to book a cab on the Saturday night in 2022 (we later discovered there was a graduation ceremony and a large wedding in town). This year with the location being closer to town this may be less of an issue.

DEPARTURE INFORMATION

Mary Attenborough Accommodation

You must vacate your room and return your key by 9:30am on the day of your departure. All room keys should be returned to the ManorCon Registration Desk.

All communal areas in the Mary Attenborough building must also be vacated at this time, the gaming space in the other building will still be accessible until 2pm on Monday.

Second Hand Games Sales Game Collection

The second-hand games sale will close at 10am on Monday 22 July 2024. Sellers should use this time to collect any remaining games. Any unsold games remaining in the second-hand games room at 2pm will be disposed of.

Closing Time

The convention finishes at 2pm on Monday.

FREQUENTLY ASKED QUESTIONS NOT COVERED ABOVE

How many people attend ManorCon?

Usually there is between 225-275 people who attend for a day or the whole convention.

What type of Games are played at ManorCon?

There are a mix of games from lighter party games, such as Just One, through to 18XX games (there are 3-5 tables of 18XX per day). To help people find games there is a games organiser online and player wanted signs at the convention.

How accessible is the new venue?

The venue is new and meets the relevant accessibility requirements. The three building we shall be using are The City Reception, The City Social Space which houses the bar and restaurant, and Mary Attenborough Accommodation Block. The accommodation will be a mixture of apartments which include ensuite rooms, dining space, sofa area and kitchen. There is also a student common area available.

Is there a games library?

There is no games library at ManorCon. People bring lots of games and usually are willing to lend if you ask or even better play with you. There are people with preview copies of games again. They may be available to borrow if you ask the owner.

QR CODE FOR THIS BOOKLET

